

 **AGEPAN**[®]

**ALSO
AVAILABLE:**
AGEPAN[®]
THD install pro –
with pre-milled
slots



AGEPAN[®] THD install

The pressure-resistant installation layer.

A brand of
SONAE 
ARAUCO

THE SMART SOLUTION FOR INDOORS

AGEPAN® THD install is a versatile wood fibre insulation board in accordance with EN 13171 for interior wall and roof insulation. Vapour-permeable, heat-insulating, and sorptive, it ensures balanced temperatures and a pleasant, comfortable indoor climate – the perfect building material for comfortable living.

Its pressure-resistant surface makes it the ideal choice – both as an installation layer and as reliable interior insulation. The solid top layer allows gypsum boards and even plaster coatings to be attached directly using approved systems (e.g. Rotkalk from Knauf Gips KG) or clay plasters.

The natural wood fibres actively contribute to a pleasant indoor climate thanks to their hygroscopic properties: stable temperatures and noticeably more living comfort. The abrasion-resistant surface and particularly clean, effortless processing make AGEPAN® THD install a convincing solution, even during processing.

Carries loads without compromise

Thanks to its unique asymmetrical raw density profile and the associated solid top layer, pictures or small shelves weighing up to 25 kg per screw can be attached without damaging the vapor barrier. Pre-drilling is not necessary.

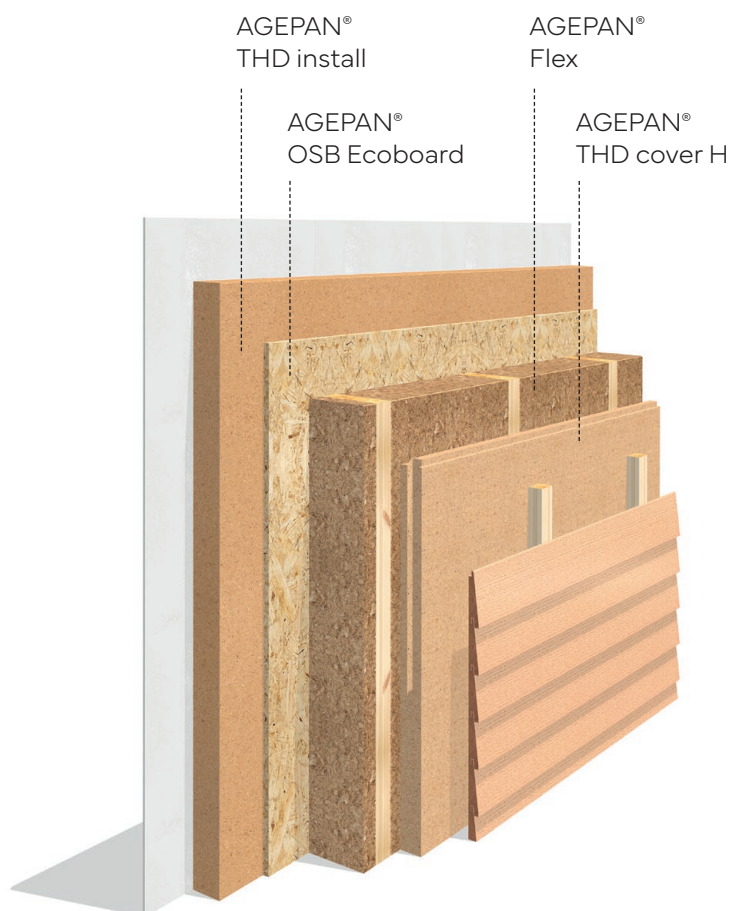

+ EASY FASTENING

Lightweight console loads, such as pictures or shelves (up to 25 kg per screw), can be attached directly without dowels or additional fastening materials. Shorter screws are sufficient, which saves time during installation and protects the vapor barrier at the same time.



+ EVERYTHING FROM A SINGLE SOURCE

Compatible, perfectly coordinated system products for maximum safety and smooth processes.

+ ABRASION-RESISTANT SURFACE

Thanks to the stable, pressure- and abrasion-resistant surface, there is less fibre abrasion in the plaster. This speeds up processing, reduces time and costs, and avoids reworking.



+ READY TO PLASTER

With approved systems such as Knauf, Claytec, etc.

+ QUALITY PRODUCT

High standards, sustainably produced in Germany – and therefore a low carbon footprint.

+ FUTURE-ORIENTED

Environmentally friendly product: wood as a natural CO₂ store, sourced 100 % from responsible, controlled and certified forestry.



Application areas Field of application according to DIN 4108-10-2021-11

Wall



Insulation of timber frame, timber board construction, and similar cavities	WH
Interior wall insulation	WI
Insulation of room partitions	WTR

Delivery information

Thickness (mm)	Edge	Format (mm)	Cover dimension (mm)	Cover dimension board (m ²)	Pieces/package	Packages/pallet	Weight/pallet (kg)
40	STD	2650 x 600	2650 x 600	1.59	28	1	430
60	STD	2650 x 600	2650 x 600	1.59	18	1	430
80	STD	2650 x 600	2650 x 600	1.59	14	1	430

Technical Data

Property	Unit	Value
Standard		EN 13171
Raw density ρ	kg/m ³	~ 230
Nominal thermal conductivity λ_D	W/mK	0.047
Rated thermal conductivity λ_B	W/mK	0.049
Water vapour diffusion resistance factor μ	-	3
Compressive stress/strength	kPa	≥ 200
Tensile strength perpendicular to the plane of the board	kPa	40 mm, 60 mm board thickness: ≥ 10 80 mm board thickness: ≥ 7,5
Short-term water absorption	kg/m ²	≤ 1
Specific thermal capacity	J/kgK	2100
Maximum application temperature	°C	110
Formaldehyde emission class		E1*, NAF (< 0.03 ppm)
Fire behavior Euroclass according to DIN EN 13501-1		E
Board marking		40 mm, 60 mm board thickness: WF-EN 13171-T3-CS(10/Y)200-TR10-WS1,0-MU3; 80 mm board thickness: WF-EN 13171-T3-CS(10/Y)200-TR7,5-WS1,0-MU3
Disposal		Waste wood category A2; waste code numbers (AVV): 030105, 170202

* Meets the requirements according to the German Chemicals Prohibition Ordinance (E05)
NAF = No-Added Formaldehyde

Building physics parameters

Property	Unit	Board thickness (mm)		
		40	60	80
Nominal value thermal resistance R_D	m ² K/W	0.80	1.20	1.60
Thermal resistance R	m ² K/W	0.75	1.15	1.50
Water vapour diffusion equivalent air layer thickness s_d	m	0.12	0.18	0.24

General information

- + Only use undamaged boards
- + Move individual boards upright
- + Protect material from moisture

If fire protection wall constructions are erected in accordance with the general building inspection test certificate (abP), fasteners and spacing must comply with the abP. The manufacturer's specifications for cladding boards and fasteners as well as the relevant building codes standards and technical rules must be observed.

Use as interior insulation and installation layer

Preparation of full-surface substrate for laying AGEPAN® THD install:

- + Suitable substrates are AGEPAN® OSB 3 Ecoboard and AGEPAN® OSB 4 Ecoboard, minimum thickness 15 mm
- + Lay and fasten OSB boards in accordance with structural requirements
- + Seal all OSB board joints, wall connections, and penetrations to ensure airtightness
- + It is recommended to check the airtightness layer, for example using a blower door test, before laying AGEPAN® THD install

Installation of AGEPAN® THD install:

- + Note the inside and outside of AGEPAN® THD install
- + **IMPORTANT: The higher-density top layer faces the room (stamped side)**
- + Boards can be laid horizontally (Fig. 1 a) or vertically (Fig. 1 b)
- + Lay the boards so that they fit precisely and the joints are tight, paying attention to the offset
- + Fasten AGEPAN® THD install to AGEPAN® OSB Ecoboard in accordance with the laying direction
- + Recessed installations can be worked into the material using standard woodworking tools
- + For a board thickness of 60 mm, AGEPAN® THD install pro can be used as an alternative

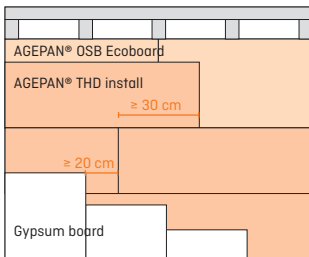

Fig. 1a: Horizontal installation
AGEPAN® THD installed on OSB
with GKB

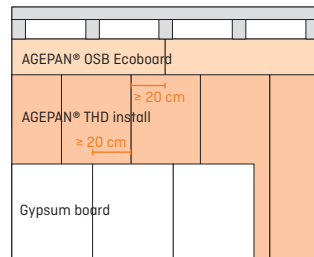

Fig. 1b: Vertical installation
AGEPAN® THD installed on OSB
with GKB

Mounting cladding boards on AGEPAN® THD install

- + Gypsum boards (GKB) max. 12.5 mm thick, other boards on request
- + Laying the GKB boards upright with offset joints to the AGEPAN® THD install according to the respective illustration
- + Gypsum boards can be fastened directly to AGEPAN® THD install in the wall area using phosphated coarse-thread screws from Dresselhaus, Spax, Knauf, Heco, and Würth or Haubold staples
- + Fastening of gypsum boards in the roof slope/ceiling area on request

Fastening 12.5 mm GKB on AGEPAN® THD install

Fasteners	Edge distance (plate edge)	Horizontally spacing	Vertically spacing
Drywall screw (coarse thread) Ø 3,9 x 35 mm	≥ 25 mm	≤ 400 mm	≤ 150 mm
Ø 5,5 x 38 mm			
Bracket Haubold KG 745 CNK (angle 30°)	≥ 25 mm	≤ 400 mm	≤ 80 mm

- + Lightweight, wall-mounted single loads with a load effect parallel to the wall, such as pictures or decorative items, can be easily fastened using wood screws with a continuous thread and a nominal diameter of at least 5 mm. Maximum load: 25 kg per screw
- + Heavier loads (e.g. wall cabinets) are mounted in the stud frame or in the inner planking of the AGEPAN® OSB Ecoboard
- + Ceiling lamps (max. 25 kg) can be fastened with wood screws with continuous thread Ø 6 x 50 mm or plasterboard dowels
- + The processing instructions of the fastener manufacturers must be observed

Fastening horizontally laid AGEPAN® THD install on AGEPAN® OSB Ecoboard

Fasteners	Distance from plate edge	Horizontally spacing	Vertically spacing
Countersunk wood screw Ø 5 mm	≥ 40 mm	≤ 625 mm	≤ 150 mm
Fasteners	Distance from plate edge	Horizontally spacing	Vertically spacing
Stapel Haubold (angle 30°) KG 700 CNK / BS 29000 for use in service class 2	≥ 15 mm	≤ 625 mm	≤ 150 mm
AGEPAN® THD install board thickness	40 mm	60 mm	80 mm
Staple length	≥ 75 mm	≥ 75 mm	≥ 100 mm

Fastening vertically installed AGEPAN® THD install on AGEPAN® OSB Ecoboard

Fasteners	Distance from plate edge	Horizontally spacing	Vertically spacing
Countersunk wood screw Ø 5 mm	≥ 40 mm	≤ 150 mm	≤ 625 mm
Fasteners	Distance from plate edge	Horizontally spacing	Vertically spacing
Stapel Haubold (angle 30°) KG 700 CNK / BS 29000 for use in service class 2	≥ 15 mm	≤ 150 mm	≤ 625 mm
AGEPAN® THD install board thickness	40 mm	60 mm	80 mm
Staple length	≥ 75 mm	≥ 75 mm	≥ 100 mm



SUSTAINABILITY IS A CORE PRIORITY FOR US.

Protecting the environment is part of our corporate culture. At Sonae Arauco, we are committed to the sustainable use of raw materials and actively uphold these principles throughout the entire production process. AGEPAN® products can contribute to meeting the challenges of climate change.



AGEPAN® shapes the future of building with sustainable wood fiber solutions that connect people and nature. We aim for every construction project to preserve the climate, and enhance quality of life – today and for future generations.

			E05	FF		MADE IN GERMANY ☆☆☆
Heat and cold protection	CO ₂ storage	Healthy living	Meets the requirements according to the German Chemicals Prohibition Ordinance	Formaldehyde-free glued	Weather resistant	Produced in Germany



Use products that are certified accordingly: PEFC certified products can be delivered on demand and within availabilities. Please specify when ordering.



Product Flyer, February 2026

Product and company names in this product flyer are trade names or registered trademarks. Reproduction is permitted only with the express approval of Sonae Arauco. Sonae Arauco assumes no liability for errors or inaccuracies. This product flyer reflects the technical status at the time of printing and applies together with other AGEPAN® documents. Installation instructions and building regulations must be observed. The suitability of the material for the intended use must be verified.



www.sonaearauco.com

Your AGEPAN® partner