

 **AGEPAN**<sup>®</sup>



**COMPLETE  
SOLUTION**

only with AGEPAN<sup>®</sup>

# AGEPAN<sup>®</sup> THDmax vario

The insulation specialist in  
large size.

A brand of  
**SONAE**   
**ARAUCO**

# THE INSULATION SPECIALIST IN LARGE SIZE

AGEPAN® THDmax vario is a vapour-permeable wood fibre insulation board that complies with EN 13171. It is completely hydrophobic and sorptive. The large format allows elements to be prefabricated quickly and economically. The board is used as wall cladding and insulation in rear-ventilated façades. The asymmetrical raw density profile gives AGEPAN® THDmax vario unique strength and ensures an abrasion-resistant surface. In addition, it offers very good heat protection and, thanks to its high heat storage capacity, reduces the need for heating and cooling energy. Furthermore, AGEPAN® THDmax vario is exceptionally easy to work with and enables clean, precise cut edges.

#### More surface area – less effort

Thanks to its large format, AGEPAN® THDmax vario enables fast working and economical results – for maximum productivity.

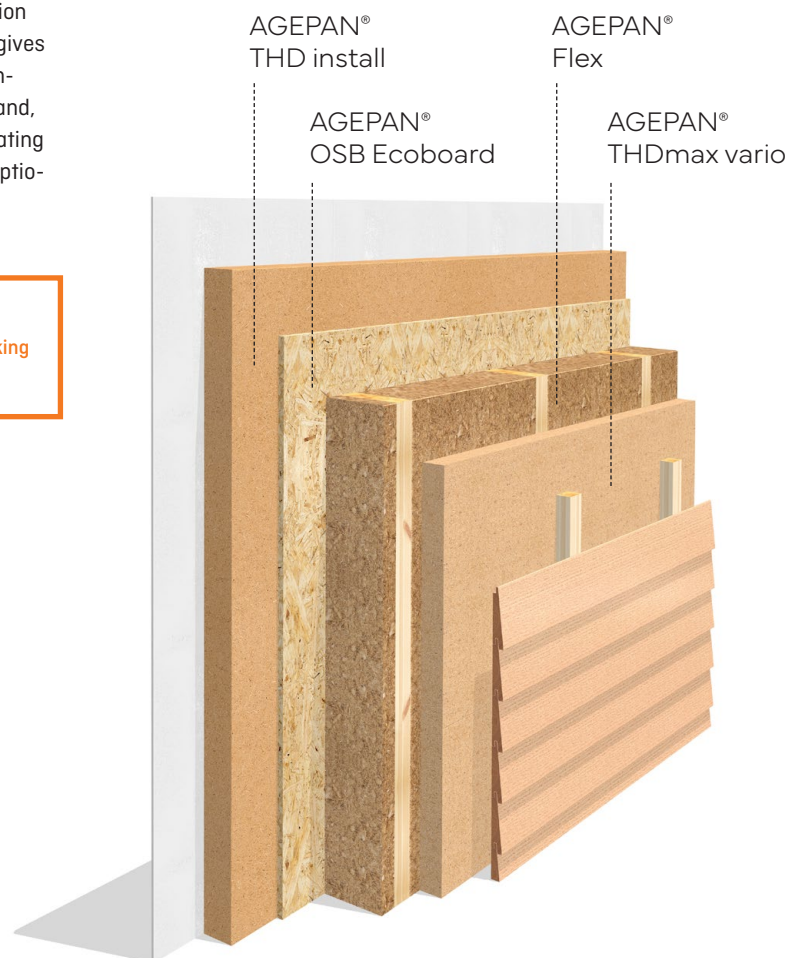

**+ PRESSURE-RESISTANT AND STABLE**

The asymmetrical raw density profile ensures extremely high stability and minimizes damage.



**+ EVERYTHING FROM A SINGLE SOURCE**

Compatible, perfectly coordinated system products for maximum safety and smooth processes.

**+ LARGE FORMAT**

Efficient and economical.

**+ HEAT PROTECTION**

Pleasant indoor climate, reduced need for air conditioning units, and thus long-term energy savings.



**+ FUTURE-ORIENTED**

Environmentally friendly product: wood is a natural CO<sub>2</sub> store that comes from 100 % responsible, controlled, and certified forestry.

**+ QUALITY PRODUCT**

High standards, sustainably produced in Germany – and therefore a low carbon footprint.

**+ ABRASION-RESISTANT SURFACE**

Less dust and dirt, better adhesion of adhesive tapes – saves primer and time.



## Application areas Field of application according to DIN 4108-10-2021-11

### Wall



External wall insulation behind cladding WAB-ds

Insulation of timber frame construction, timber board construction and comparable compartments WH

## Delivery information

Thickness (mm)	Edge	Format (mm)	Cover dimension (mm)	Cover dimension board (m <sup>2</sup> )	Pieces/package	Packages/pallet	Weight/pallet (kg)
40*	STD	3000 x 1250	3000 x 1250	3.75	28	1	1000
60	STD	3000 x 1250	3000 x 1250	3.75	18	1	1000
80	STD	3000 x 1250	3000 x 1250	3.75	14	1	1000
40* **	STD	6000 x 2550	6000 x 2550	15.0	16	1	2280
60**	STD	6000 x 2550	6000 x 2550	15.0	12	1	2560

\* On request

\*\* Unedged on the long side

## Technical Data

Property	Unit	Value
Standard		EN 13171
Raw density $\rho$	kg/m <sup>3</sup>	~ 230
Nominal thermal conductivity $\lambda_D$	W/mK	0.047
Rated thermal conductivity $\lambda_B$	W/mK	0.049
Water vapour diffusion resistance factor $\mu$	-	3
Compressive stress/strength	kPa	≥ 200
Tensile strength perpendicular to the plane of the board	kPa	≥ 10
Short-term water absorption	kg/m <sup>2</sup>	≤ 1
Specific thermal capacity	J/kgK	2100
Maximum application temperature	°C	110
Formaldehyde emission class		E1*; NAF (< 0.03 ppm)
Fire behavior Euroclass according to DIN EN 13501-1		E
Outdoor exposure		up to 8 weeks
Board marking		WF-EN 13171-T3-CS(10/Y)200-TR10-WS1,0-MU3
Disposal		Waste wood category A2; waste code numbers (AVV): 030105, 170201

\* Meets the requirements according to the German Chemicals Prohibition Ordinance (E05)

NAF = No-Added Formaldehyde

## Building physics parameters

Property	Unit	Board thickness (mm)		
		40	60	80
Nominal value thermal resistance $R_D$	m <sup>2</sup> K/W	0.80	1.20	1.60
Thermal resistance R	m <sup>2</sup> K/W	0.75	1.15	1.50
Water vapour diffusion equivalent air layer thickness $s_d$	m	0.12	0.18	0.24

## General information

- + Only use undamaged boards
- + Move individual boards in an upright position, if possible
- + Store and use boards in a dry place
- + Protect edges from damage

## Sealing joints and penetrations

- + Joints, connections and penetrations must be windproof and rainproof sealed with suitable adhesive tape
- + The following adhesive tapes are recommended for this purpose: e.g., pro clima® / TESCON VANA, Ampack / Ampacoll XT, and SIGA / SIGA Wigluv®, each with primer. Follow the manufacturer's instructions

## Use in wall areas with ventilated façades

- + Boards can be laid directly onto the supporting structure
- + Note the inside and outside (stamping on the outside)
- + The following grid dimension is recommended: 62.5 cm
- + Lay the boards so that they fit precisely and the joints are tight
- + Non-supported board edges are not permitted
- + The boards must be fixed in place during installation and then secured with the counter batten

Design aids for counter batten fastening for façades can be found at [www.sonaearauco.com](http://www.sonaearauco.com)

## Outdoor exposure

- + Exposure of installed boards to natural weathering conditions are limited extent of up to 8 weeks
- + If subsequent work is delayed, temporary suitable film covering may be advisable
- + In the event of moisture absorption, ensure that the boards are dried back to their normal moisture content, taking into account possible changes in board length during construction
- + Connections and tape seals must be rainproof and windproof

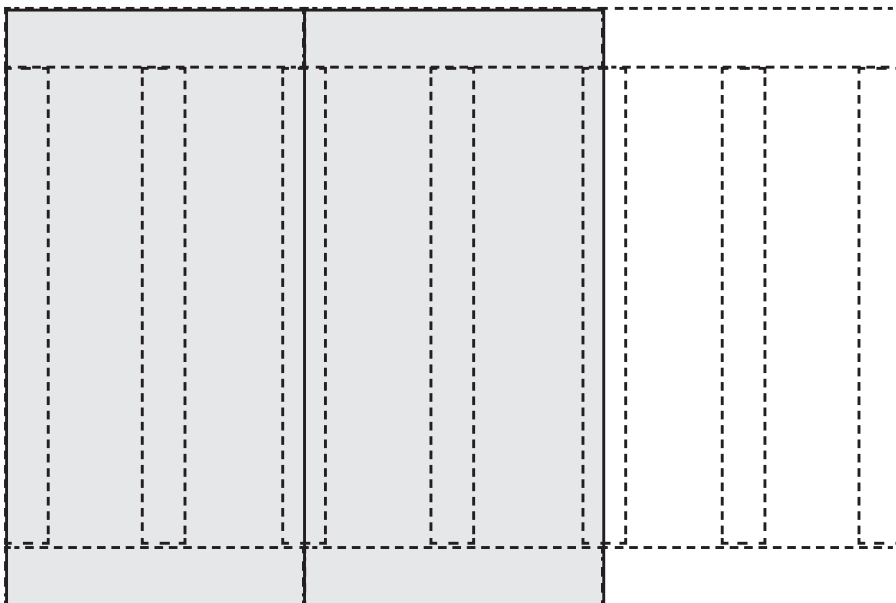



## SUSTAINABILITY IS A CORE PRIORITY FOR US.

Protecting the environment is part of our corporate culture. At Sonae Arauco, we are committed to the sustainable use of raw materials and actively uphold these principles throughout the entire production process. AGEPAN® products can contribute to meeting the challenges of climate change.



**AGEPAN® shapes the future of building** with sustainable wood fiber solutions that connect people and nature. We aim for every construction project to preserve the climate, and enhance quality of life – today and for future generations.

			<b>E05</b>	<b>FF</b>		<b>MADE IN GERMANY</b> ☆☆☆
Heat and cold protection	CO <sub>2</sub> storage	Healthy living	Meets the requirements according to the German Chemicals Prohibition Ordinance	Formaldehyd-free glued	Weather resistant	Produced in Germany



Use products that are certified accordingly: PEFC certified products can be delivered on demand and within availabilities. Please specify when ordering.



### Product Flyer, February 2026

Product and company names in this product flyer are trade names or registered trademarks. Reproduction is permitted only with the express approval of Sonae Arauco. Sonae Arauco assumes no liability for errors or inaccuracies. This product flyer reflects the technical status at the time of printing and applies together with other AGEPAN® documents. Installation instructions and building regulations must be observed. The suitability of the material for the intended use must be verified.



[www.sonaearauco.com](http://www.sonaearauco.com)

Your AGEPAN® partner